

REV.	DESCRIPTION	DATE	ENG	ECO #	APPR
-	RELEASED FOR PRODUCTION				

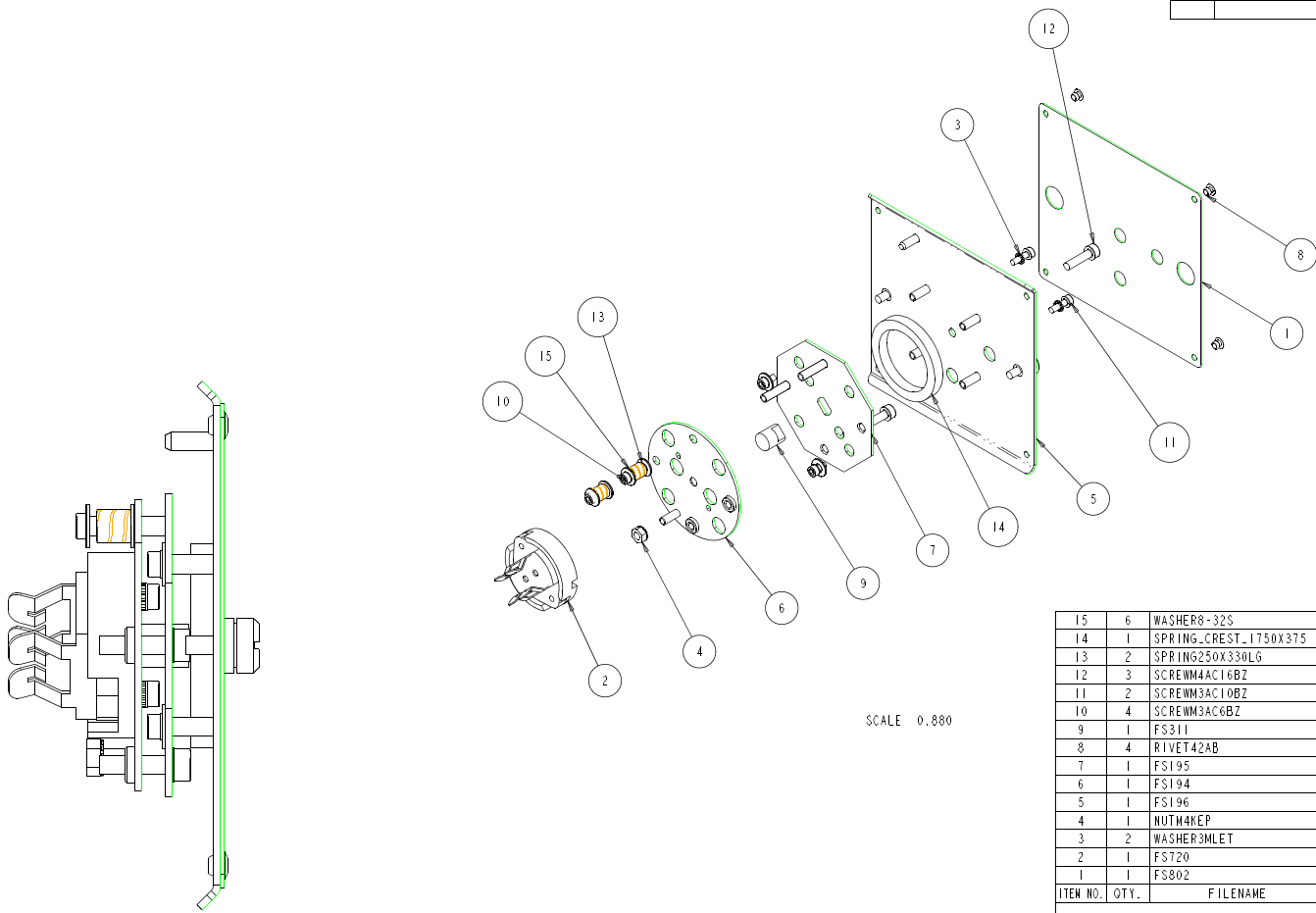

SCALE 0.880

15	6	WASHER8-32S	90706009	WASHER, #8 FLAT SS .174 X .375 X .032
14	1	SPRING_CREST_1750X375	90701191	SPRING, CREST TO CREST .375
13	2	SPRING250X330LG	90701002	SPRING, #88 (.250 DIA x .33 LG)
12	3	SCREW#4AC16BZ	91000416	SCREW, M4 SOCKET CAP 16 BZ SEMS
11	2	SCREW#3AC10BZ	91000310	SCREW, M3 SOCKET CAP 10 BZ SEMS
10	4	SCREW#3AC6BZ	91000306	SCREW, M3 SOCKET CAP 06 BZ SEMS
9	1	FS311	90701270	ROCKER, LAMP ADJUST X-SPOT
8	4	RIVET42AB	90701134	RIVET, DOMED, STYLE 42, 1/8 SHANK, BLIND
7	1	FS195	99080130	PLATE, LAMP Z ADJUST
6	1	FS194	99080131	PLATE, LAMP TILT
5	1	FS196	80071617	PLATE, LAMP REMOVAL
4	1	NUT#4KEP	91201204	NUT, M4 KEPS
3	2	WASHER3MLET	90706006	LOCK WASHER, #6 EXTERNAL TOOTH SZ
2	1	FS720	99150022	LAMP WIRE AND SOCKET ASSY; X-SPOT
1	1	FS802	99310354	LABEL, LAMP CAP WARNING, X-SPOT
ITEM NO.	QTY.	FILENAME	PART NO.	DESCRIPTION
BILL OF MATERIALS				

**PROPRIETARY NOTICE:**  
 THIS DOCUMENT CONTAINS CONFIDENTIAL AND PROPRIETARY INFORMATION OF HIGH END SYSTEMS, INC., (ALSO DBA LIGHTWAVE RESEARCH) AND IS GIVEN TO THE RECEIVER IN CONFIDENCE. THE RECEIVER ACCEPTS AND AGREES THAT, EXCEPT AS AUTHORIZED BY HIGH END SYSTEMS, THE RECEIVER WILL NOT PERMIT THE USE OF THE DOCUMENT OR ANY COPY THEREOF OR THE INFORMATION THEREIN, WILL NOT COPY OR PERMIT COPYING THE DOCUMENT WILL NOT DISCLOSE TO OTHERS EITHER THE DOCUMENT OR THE INFORMATION THEREIN, AND WILL UPON COMPLETION OF THE NEED TO RETAIN THE DOCUMENT, OR UPON DEMAND, RETURN THE DOCUMENT WITHOUT RETAINING ANY OF THE INFORMATION CONTAINED THEREIN IN ANY FORM WHATSOEVER.

UNLESS OTHERWISE SPECIFIED	RELEASE DATE: MAR 19, 2001	CE:	2209 WEST BRANER LANE AUSTIN, TEXAS 78758 (512) 832-0363 FAX (512) 832-8542 ***** <a href="http://www.highend.com">http://www.highend.com</a>	LIGHTWAVE RESEARCH
DIMENSIONAL TOLERANCES:	ENG: D FRANKLIN	QA:		
0 PLACE DECIMAL = ±0.38	ME:	DRW: R. VILLARREAL		
1 PLACE DECIMAL = ±0.25	MFG:			
2 PLACE DECIMALS = ±0.13	ANGLES = ±0.5°			
FOR PAINTED PARTS REFER TO ENS. SPEC. MANUAL SOP-4.4.2	DESCRIPTION: CAP, ASSY LAMP X-SPOT	FINISH: NA		
MIN. DRAFT	MATERIAL: CHARTED	PART NO. 80300014		
MIN. RADII	INTERPRET DIMENSIONS PER ASME Y14.5M-1994	DRAWING NO. FSA085		
FLATNESS	THIRD ANGLE PROJECTION	REV. -		
THICKNESS	DIMENSIONS ARE IN MILLIMETERS	DO NOT SCALE SCALE: 2,000 SHEET: 1 OF 1		
VOLUME				